

MULTILIFT SELECT 4

Machine size: 270-520

Handling weight: 4 kg

ARBURG

TECHNICAL DATA | MULTILIFT SELECT 4

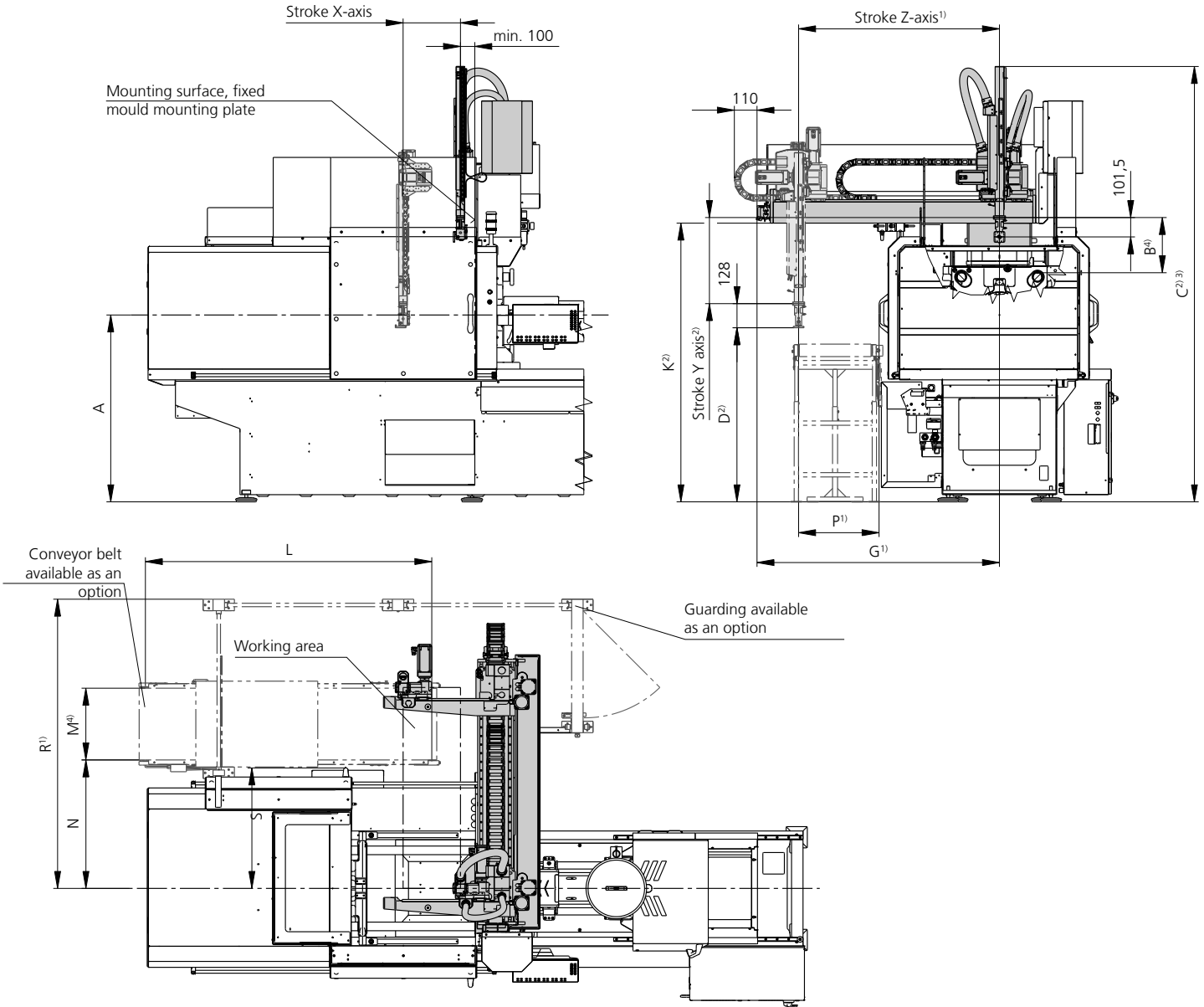

- 1) Stroke extension Z-axis option
- 2) Stroke extension Y-axis option
- 3) From size 370, overhead clearance can be increased by 200 mm as an option
- 4) Wider conveyor belt possible in conjunction with extension of the Z-axis

TECHNICAL DATA | MULTILIFT SELECT 4

Machine type	Dim. A	Dim. B	Dim. C	Dim. D	Dim. G		Dim. K	Conveyor belt		Dim. N	Dim. P		Dim. R ¹⁾		Dim. S
		Standard	Standard	Standard	Standard	Extended ¹⁾		Dim. L	Dim. M ¹⁾		Standard	Extended ¹⁾	Standard	Extended	
	mm	mm	mm	mm	mm	mm	mm	mm	mm	mm	mm	mm	mm	mm	mm
270 A / H	1.220	434	3.095	1.106	1.320	1.720	1.795	1.500	400	615	440	840	1.635	2.035	560
270 S	1.170	434	3.045	1.056	1.320	1.720	1.745	1.500	400	615	440	840	1.635	2.035	560
270 C GOLDEN EDITION	1.169	392	3.000	1.013	1.320	1.720	1.702	1.500	400	550	520	920	1.660	2.060	480
320 C GOLDEN EDITION	1.169	367	3.000	1.013	1.290	1.720	1.702	1.500	400	550	520	920	1.660	2.060	480
370 A / H / S	1.220	379 ²⁾	3.095	1.106	1.320	1.720	1.795 ²⁾	1.500	400	740	240	640	1.610	2.010	760
E GOLDEN ELECTRIC													(1.760 ⁵⁾)		
420 C GOLDEN EDITION	1.249	374 ²⁾	3.150	1.165	1.320	1.720	1.854 ²⁾	2.000	500	615	440	840	1.740	2.140	560
470 A / H / S	1.302	384 ²⁾	3.240	1.253	1.720	2.120	1.942 ²⁾	2.000	500	895	560	960	2.015	2.415	840
E GOLDEN ELECTRIC															
470 C GOLDEN EDITION	1.249	369 ²⁾	3.185	1.200	1.320	1.720	1.889 ²⁾	2.000	500	615	440	840	1.740	2.140	560
520 A / H / S	1.348	444 ²⁾	3.585	1.199	1.720	2.120	2.088 ²⁾	2.000	500	895	560	960	2.015	2.415	840
E GOLDEN ELECTRIC															

Main axes

Machine type	Handling weight ³⁾ max. kg	Z-axis			Y-axis			X-axis		Weight Robot Standard kg
		Stroke		Speed	Stroke		Speed	Stroke	Speed	
		Standard mm	Extended ¹⁾ mm	max. mm/s	Standard mm	Extended ¹⁾ mm	max. mm/s	mm	max. mm/s	
270 A / H / S	4	1.000	1.400	2.000	600	---	4.000	500	2.000	250
270 C GOLDEN EDITION	4	1.000	1.400	2.000	600	800	4.000	500	2.000	250
320 C GOLDEN EDITION	4	1.000	1.400	2.000	600	800	4.000	500	2.000	250
370 A / H / S	4	1.000	1.400	2.000	600	800	4.000	500	2.000	250
E GOLDEN ELECTRIC										
420 C GOLDEN EDITION	4	1.000	1.400	2.000	600	800	4.000	500	2.000	250
470 A / H / S	4	1.400	1.800	2.000	600	800	4.000	500	2.000	270
E GOLDEN ELECTRIC										
470 C GOLDEN EDITION	4	1.000	1.400	2.000	600	800	4.000	500	2.000	250
520 A / H / S	4	1.400	1.800	2.000	800	1.000	4.000	500	2.000	280
E GOLDEN ELECTRIC										

Auxiliary axes (gripper axes)

C-axis	
Torque	Weight
Nm	kg
7	0,9

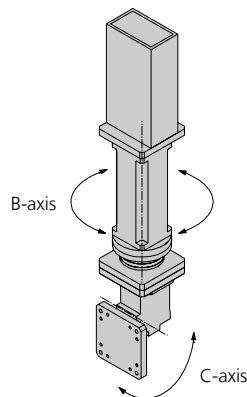

*) Optional

- 1) Wider conveyor belt possible in conjunction with extension of the Z-axis
- 2) From size 370, overhead clearance can be increased by 200 mm as an option
- 3) Gripper plus part weight plus weight of auxiliary axes (B, C axis)
- 4) at 6 bar pressure level
- 5) 370 S with hydraulic accumulator

EQUIPMENT | MULTILIFT SELECT 4

The requirement for the use of the MULTILIFT SELECT is an ARBURG ALLROUNDER.

Axes

- Main axes with servo-electric drive for rapid, simultaneous movements with a high repeat accuracy
- C-axis with pneumatic drive for swivelling the finished parts

Pneumatic valves for grippers

- Pneumatic valves for actuating gripper functions, such as grippers, gripper jaws, cylinders, lifting and rotary units (see additional information):
 - 1 with blocked central position (5/3)
- Additional pneumatic valves (maximum 3) in any combinations of the following versions (see additional information):
 - with blocked central position (5/3)
 - with vented central position (5/3)
- All pneumatic valves connected to the gripper flange with rapid connect couplings

Vacuum equipment for grippers

- Vacuum equipment (Venturi effect) for parts handling with suction pads
- Additional vacuum units (maximum 3)
- All vacuum units connected close to the gripper via hoses. Including vacuum switches for parts monitoring
- Air blow function for reliable parts transfer
- Air saving function

Pneumatic maintenance unit

- Manually-adjustable filter pressure reducer for adjusting the pressure level
- Electric on/off function

Control

- Sequence programming with symbols via SELOGICA. Teach-in function for user-friendly sequence programming
- Display selection via function and direct access keys
- Cycle step display in sequence diagram
- Robotic system can be moved in units analogous to the cycle sequence
- Three different speeds can be selected in manual mode for fast and reliable programming. Axes can be moved progressively or incrementally (0.1 mm, 1 mm or 10 mm)
- Programmable sequence branches for reliable separation of random samples, rejects and sprues
- Data record for robotic system integrated in data record for injection moulding machine
- Synchronous movements of robotic system with ejector and mould opening movement
- Interface between robotic system and injection moulding machine
- Mobile ARBURG Mobile SELOGICA (AMS) control panel for easy and flexible operation

Inputs/outputs for grippers

- Interface with 8 freely programmable inputs for monitoring sensors for gripper functions. All inputs connected to plugs, including counterplug

- Freely programmable outputs for actuating pneumatic valves for gripper functions. All outputs directly connected to pneumatic valves

Inputs/outputs for peripherals

- Interface (24V DC) with 4 freely programmable inputs and outputs for peripherals. Connected to 42-pin connector on MULTILIFT, including counterplug
- Interface (24V DC) with 8 freely programmable inputs and outputs for peripherals. Connected to 29-pin connector on MULTILIFT, including counterplug
- Basis: max. 2 interfaces with a total of max. 16 inputs and outputs possible

Guards

- Electrical equipment for protecting one door within the guard fence, fully connected on the machine, including the following:
 - 2 emergency stop buttons
 - 1 acknowledge button
 - 3 switches for door
- Corrugated wire mesh guard for housing the robotic system
- Compact protection
- Fold-away divider chute integrated into compact protection

Additional options

- Conveyor belt for setting down parts, including interface, expandable to include clear button
- Universally adjustable removal hand with up to 4 suction devices. Size and design adapted to the machine type and application
- Sprue grippers, pneumatically operated with spring return movement

Additional information

- Pneumatic valve 5/3 with blocked central position for gripper functions, the position of which should be maintained when not actuated, for example, if the safety guard is open, EMERGENCY STOP
- Pneumatic valve 5/3 with vented central position for gripper functions, which should be depressurised when not actuated, in order to ensure part-protecting transfer via the machine-side ejector, for example.

■ Basic machine

○ Optional

GRIPPER ADAPTATIONS | MULTILIFT SELECT 4

Assignment interface X001 gripper inputs S 5001 - S 5008					
Pin no.	Function	Designation	Pin no.	Function	Designation
1	S 5001		14	S 5005	
2	+ 24 V	Gripper input 1	15	+ 24 V	Gripper input 5
3	GND		16	GND	
4	S 5002		17	S 5006	
5	+ 24 V	Gripper input 2	18	+ 24 V	Gripper input 6
6	GND		19	GND	
7	S 5003		20	S 5007	
8	+ 24 V	Gripper input 3	21	+ 24 V	Gripper input 7
9	GND		22	GND	
10	S 5004		23	S 5008	
11	+ 24 V	Gripper input 4	24	+ 24 V	Gripper input 8
12	GND		25	GND	
13	PE				

Detail E: Gripper flange of vertical axis

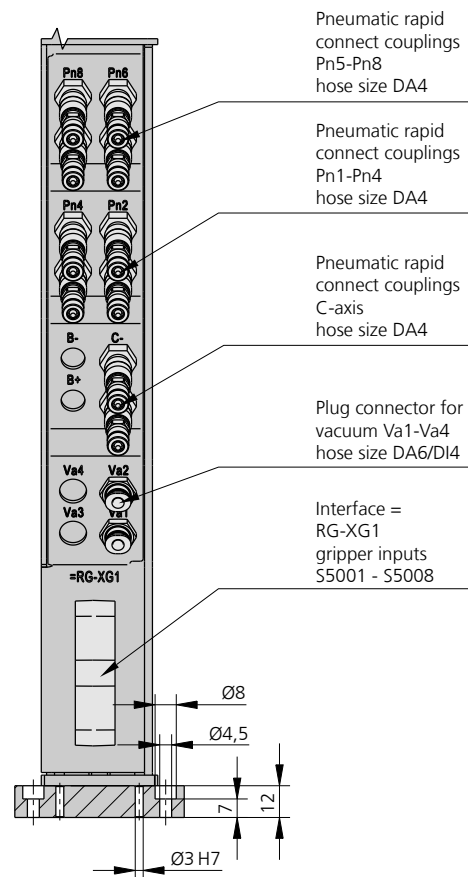
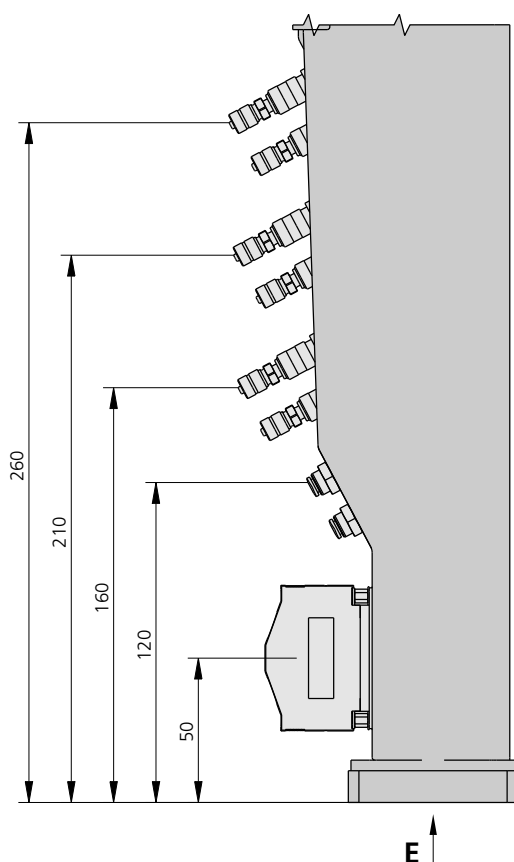
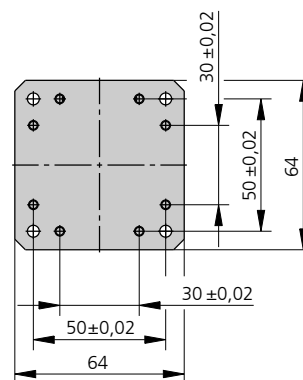

SECONDARY AXES | MULTILIFT SELECT 4

C axis (pneumatic)

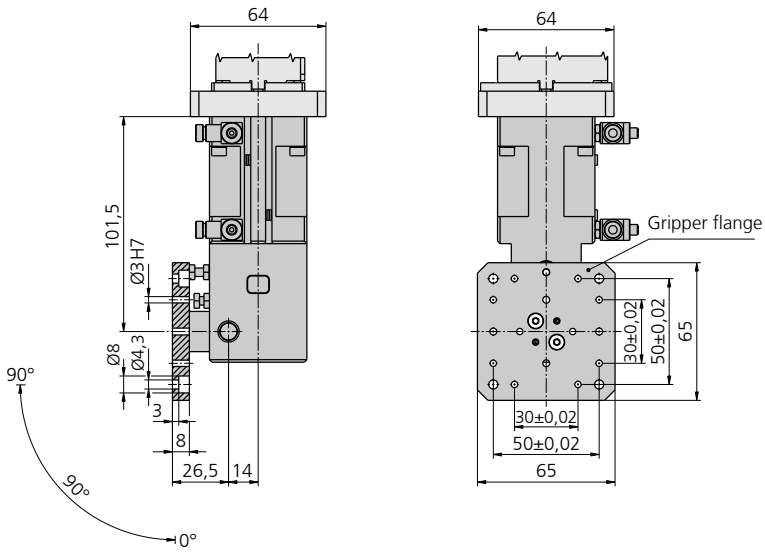

ARBURG GmbH + Co KG

Arthur-Hehl-Strasse
 72290 Lossburg
 Tel.: +49 7446 33-0
 www.arburg.com
 contact@arburg.com